

Boundary Treatment | Southern Section | 1:1000

Legend

- BOUNDARY TYPE 1**
Proposed 1.2m high timber post and rail fence with welded mesh.
Refer to Detail 1, dwg 106
- BOUNDARY TYPE 2**
Proposed 1.8m high, concrete post and timber panel fence.
Refer to Detail 2, dwg 106
- BOUNDARY TYPE 3**
Existing vegetated boundary to be retained and enhanced.
- BOUNDARY TYPE 4**
Proposed vegetated boundary to link with existing.
- BOUNDARY TYPE 5**
Proposed formal hedge to define space to front of each house.
- BOUNDARY TYPE 6**
2.4m high rigid mesh fence.
- BOUNDARY TYPE 7**
Proposed 1.8m high blockwork wall, render finish to public realm side.
Finish to match architectural facade of buildings.
Refer to Detail 3, dwg 106
- BOUNDARY TYPE 8**
1.8m high rigid mesh fence.

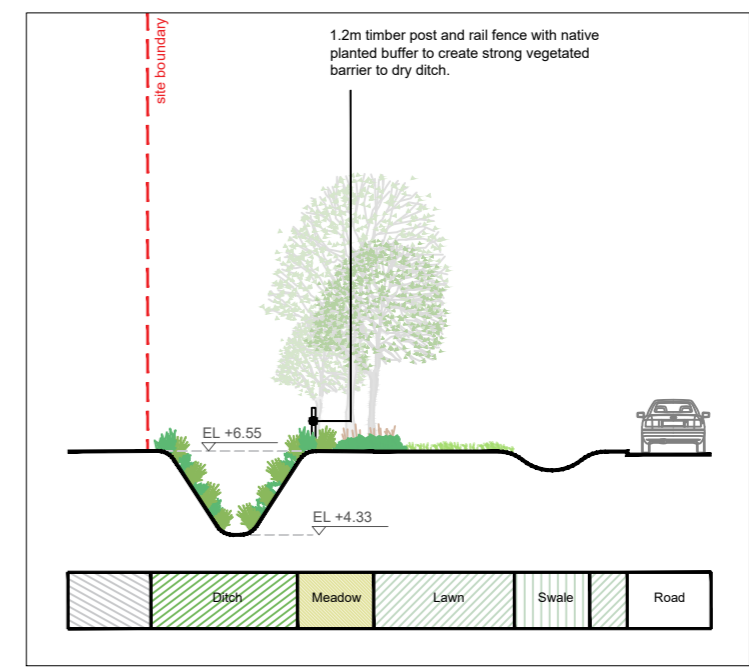

Section G-G | 1:200

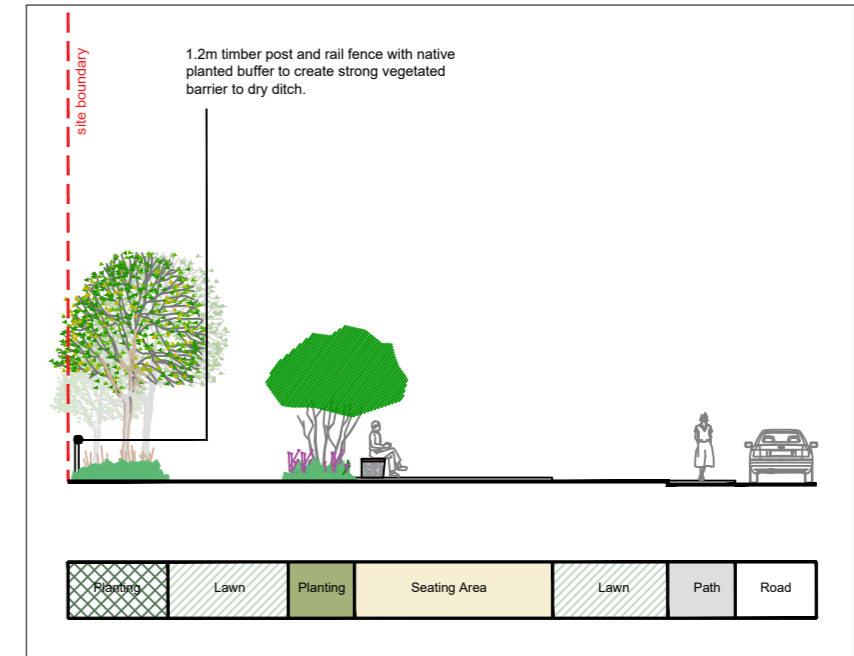

Section H-H | 1:200

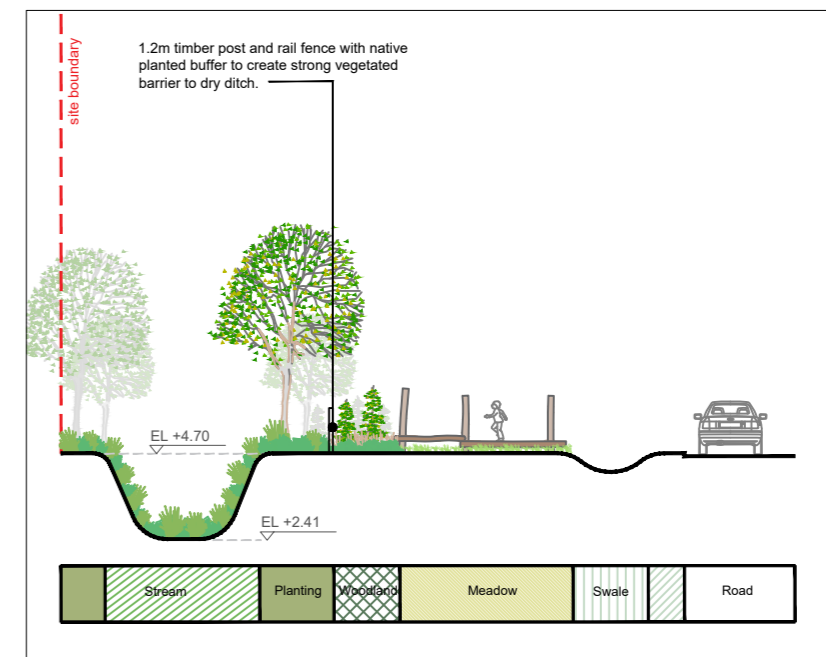

Section I-I | 1:200

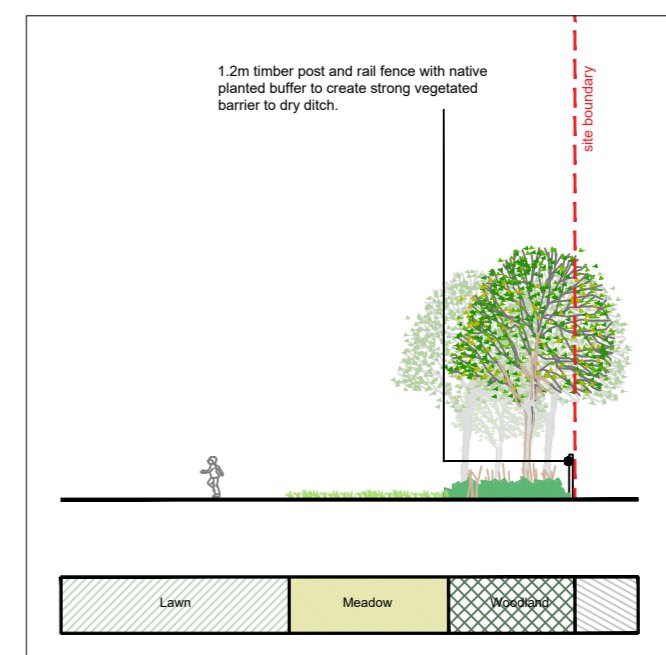

Section J-J | 1:200

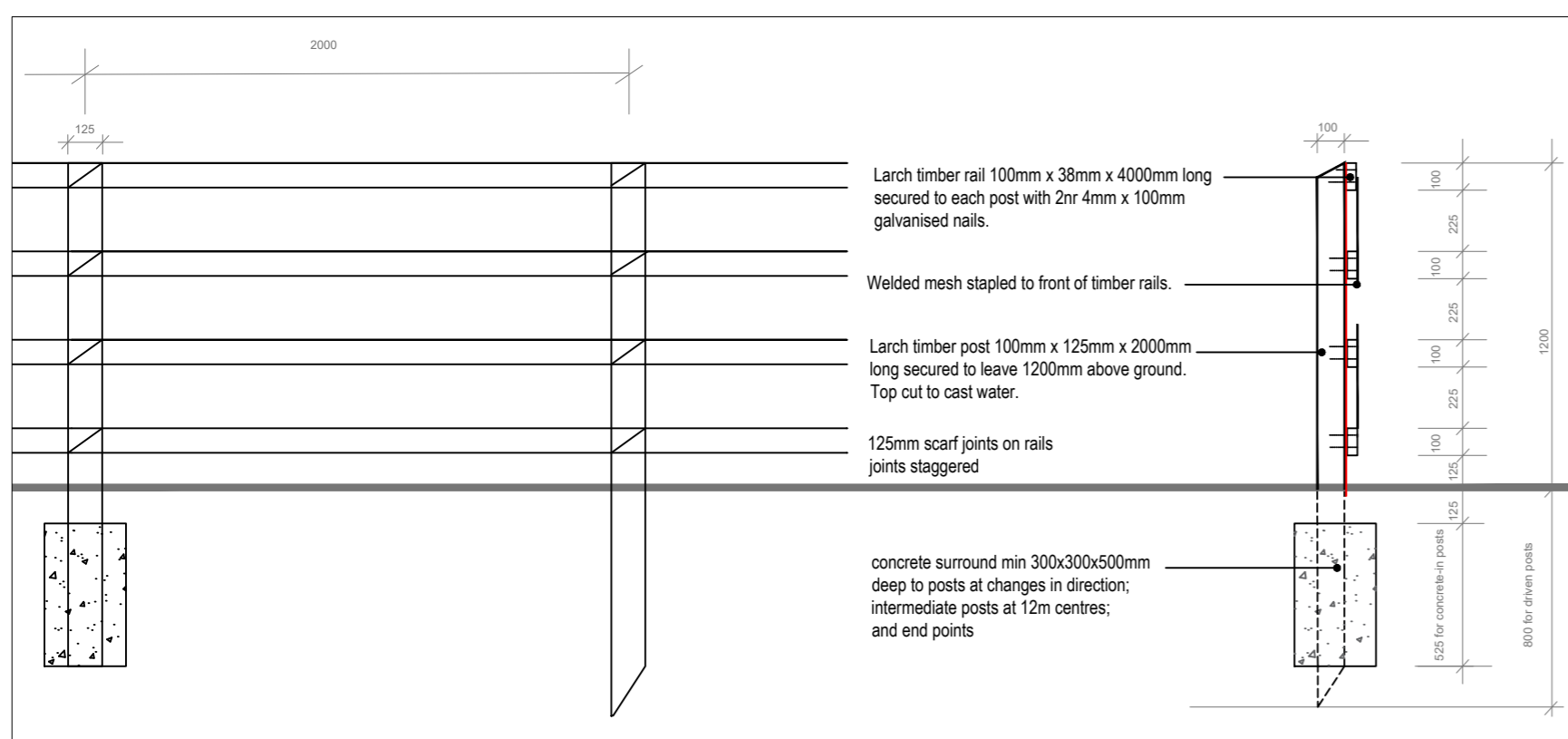

D01 Detail of 1.2m high timber post and rail fence with welded mesh
106 SCALE | 1:25 BOUNDARY TYPE 1

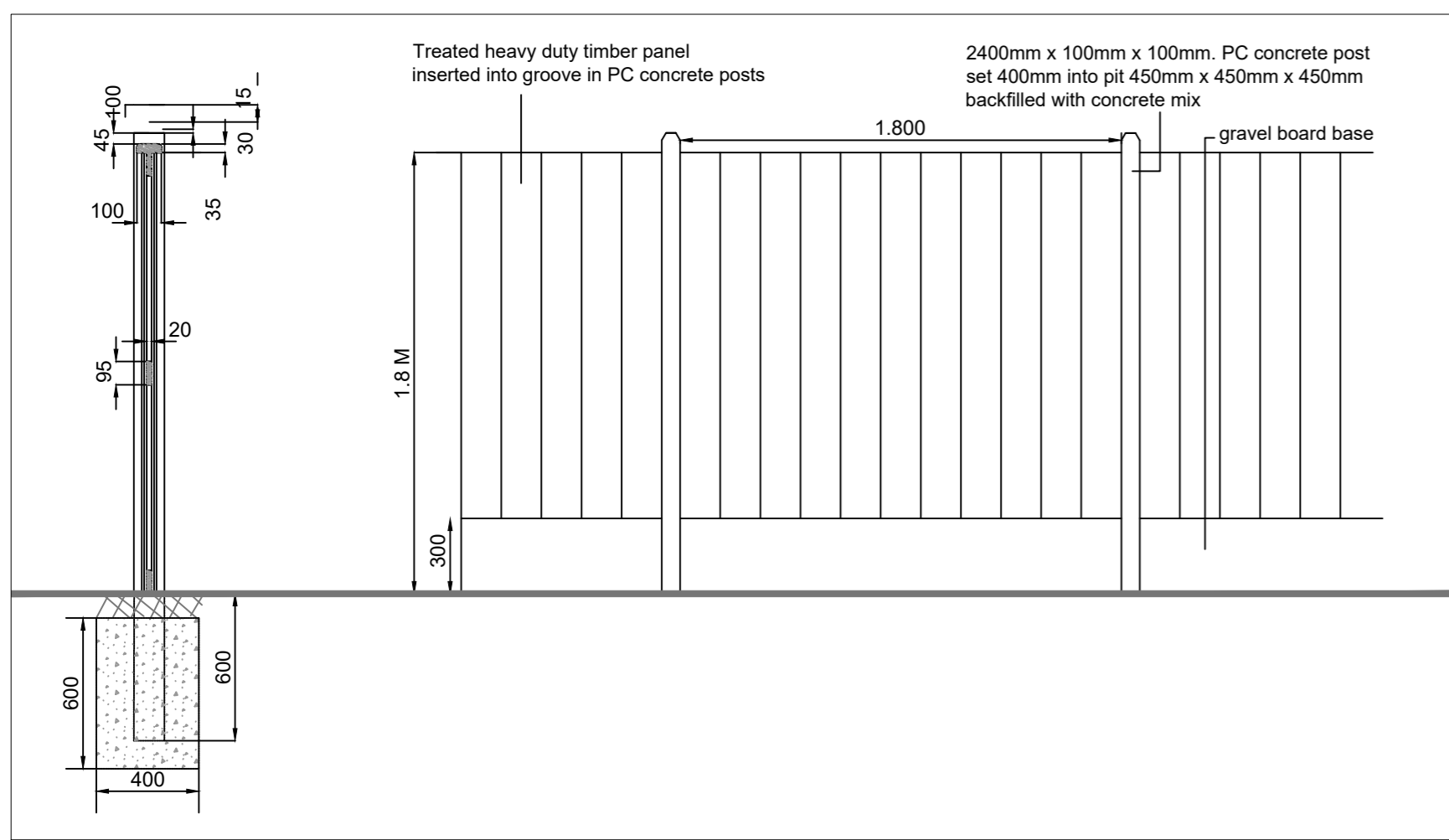

D02 Detail of 1.8m high, concrete post and timber panel fence
106 SCALE | 1:25 BOUNDARY TYPE 2

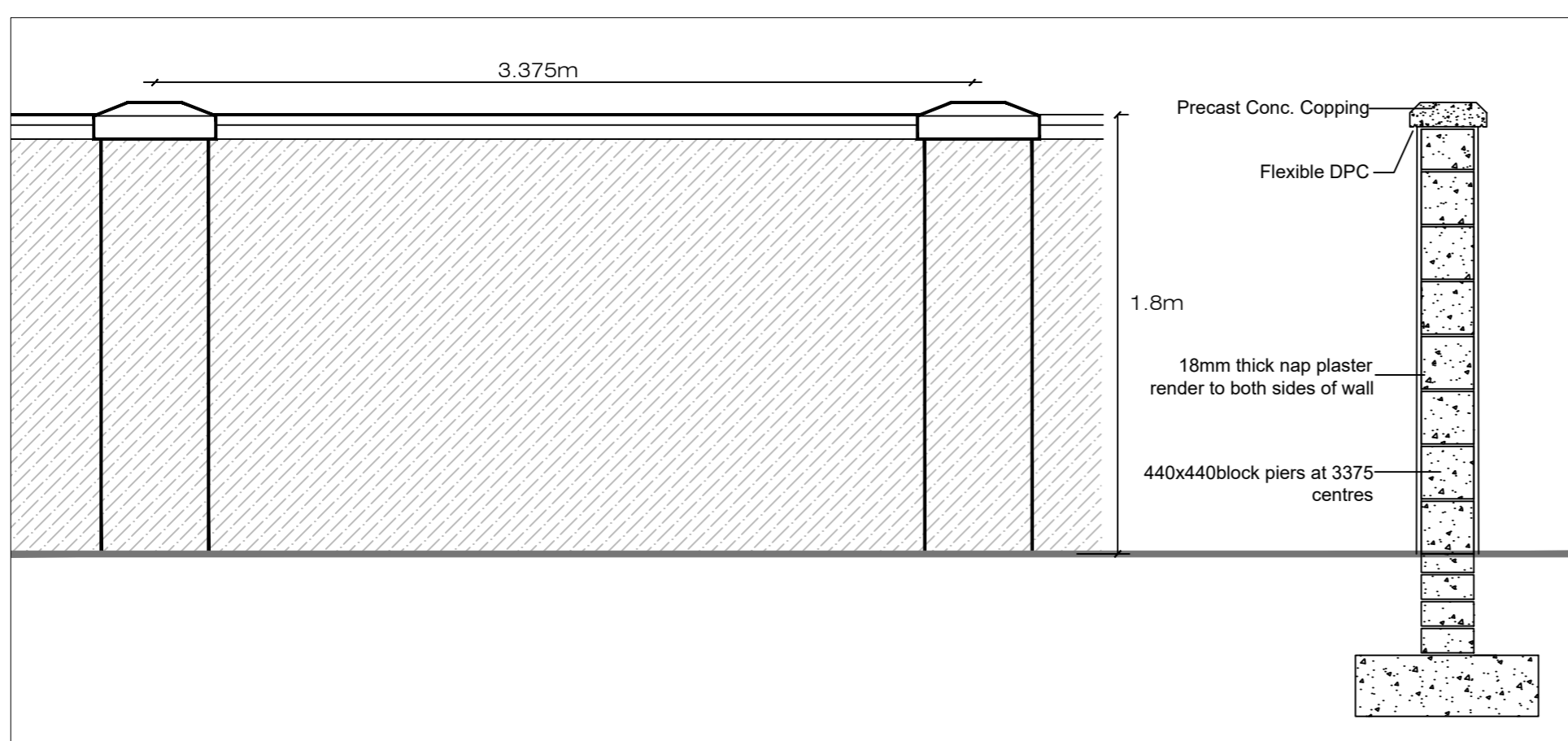

D03 Detail of 1.8m high blockwork wall with render finish
106 SCALE | 1:25 BOUNDARY TYPE 7

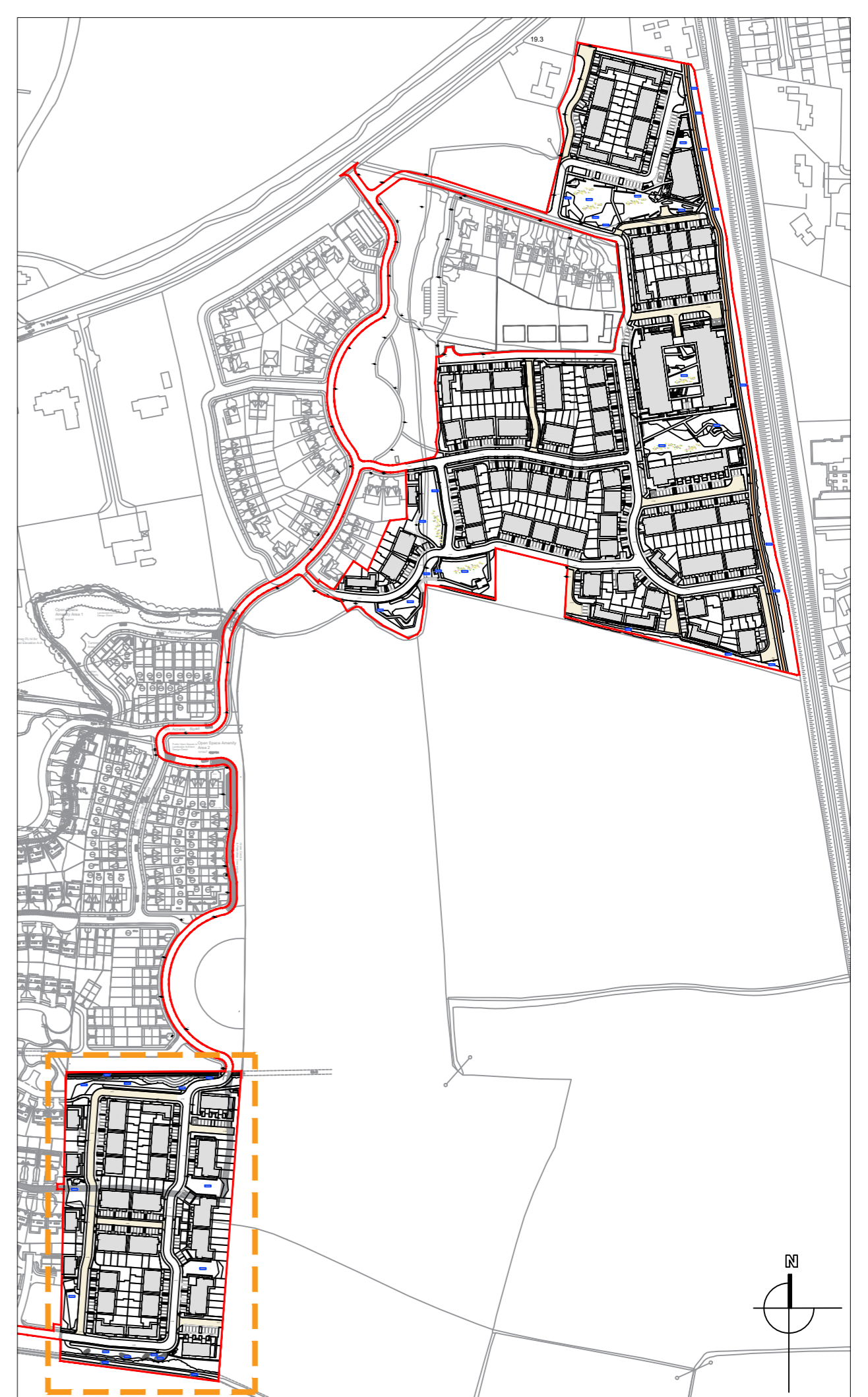

Key Plan | NTS

THIS DRAWING IS COPYRIGHT ©
notes DO NOT SCALE figured dimensions only to be taken from this drawing

JOB	Broomfield SHD, Malahide, Co. Dublin for Birchwell Developments Ltd.	Scale	As Shown @ A1	Status	PLANNING
		Date	13.04.22	Dr.	JMCC
JOB No.	Boundary Treatment - Southern Section	Job No.	0389	Drawn No.	106
		Rev.			
Kevin Fitzpatrick Landscape Architecture		4 Main Street Raheny Dublin 5 E-info@kfla.ie W- www.kfla.ie			